

ERGOTIG 20







CE EN60974-7

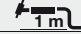

CODE	↔	↔	↔
------	---	---	---

SV1410-00	4 m	12.5'	sintig	
SV1810-00	8 m	25'	sintig	
SV2410-00	4 m	12.5'	dual	
SV2810-00	8 m	25'	dual	

TECHNICAL DATA	
----------------	--

	
	0,85 kg 1.87 lb
V PEAK	113
	Argon
	0,5 ÷ 3,2 mm .020" ÷ 1/8"
X 100%	250A DC - 220A AC
	4 bar
	1.5 l/min

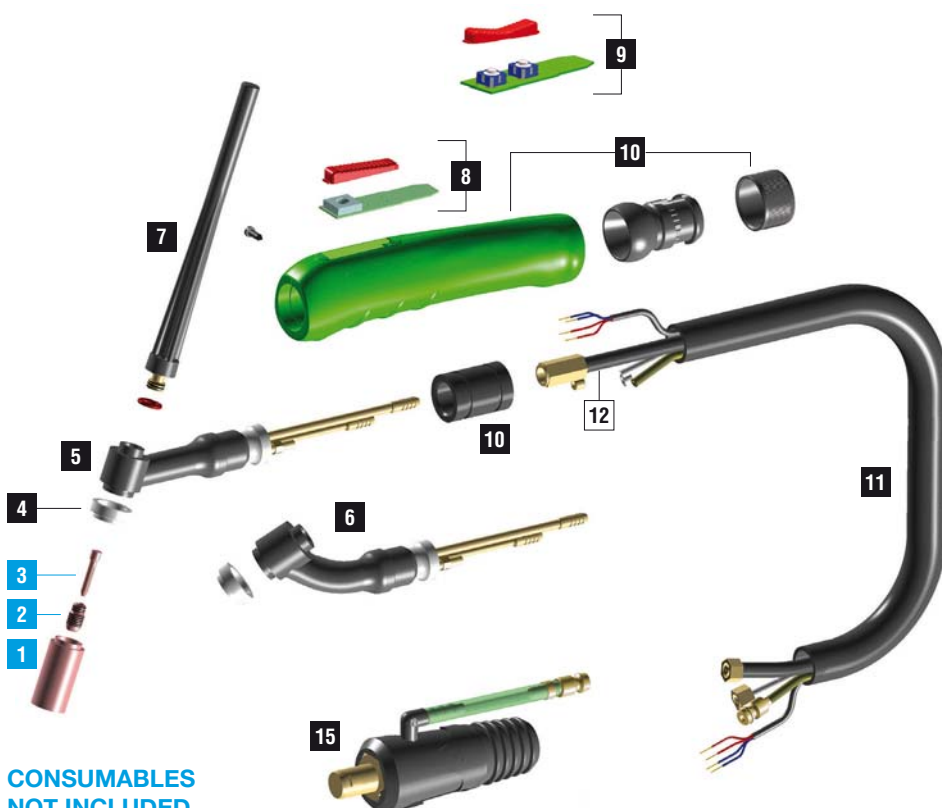
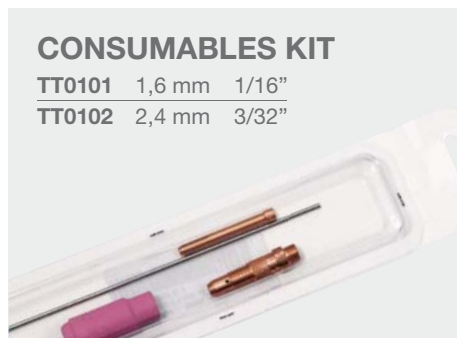

CONSUMABLES NOT INCLUDED

	CODE		Gr	Ø		↔	REF	
1	TC0012		4	6,4 mm	1/4"		13N08	10
1	TC0013		5	8 mm	5/16"		13N09	10
1	TC0014		6	9,8 mm	3/8"		13N10	10
1	TC0015		7	11,2 mm	7/16"		13N11	10
1	TC0016		8	12,7 mm	1/2"		13N12	10
1	TC0017		10	15,7 mm	5/8"		13N13	10
1	TC0096		4	6,5 mm	1/4"		796F71	10
1	TC0097		5	8 mm	5/16"		796F72	10
1	TC0098		6	9,5 mm	3/8"		796F73	10
1	TC0101		4	6,5 mm	1/4"		796F75	10
1	TC0102		5	8 mm	5/16"		796F76	10
1	TC0103		4	6,5 mm	1/4"		796F79	10
2	TE0003-05			0,5 mm	.020"		13N25	10
2	TE0003-10			1,0 mm	.040"		13N26	10
2	TE0003-16			1,6 mm	1/16"		13N27	10
2	TE0003-20			2,0 mm	5/64"		-	10
2	TE0003-24			2,4 mm	3/32"		13N28	10
2	TE0003-32			3,2 mm	1/8"		13N29	10
3	TD0003-05			0,5 mm	.020"		13N20	10
3	TD0003-10			1,0 mm	.040"		13N21	10
3	TD0003-16			1,6 mm	1/16"		13N22	10
3	TD0003-20			2,0 mm	5/64"		-	10
3	TD0003-24			2,4 mm	3/32"		13N23	10
3	TD0003-32			3,2 mm	1/8"		13N24	10

7	BW0063					147,5 mm	41V24	10
7	BW0064					53 mm	41V35	10
7	BW0065					17,5 mm	41V33	10
7	EA0129							10

CODE				
------	--	--	--	--

4	TQ0001		insulator	10
5	TG0020		tig torch head	1
6	TG0220		tig torch head flex	1
6	TG0223		tig torch head Flex 125 mm	1
8	TT0181		kit Ergotig single	1
9	TT0182		kit Ergotig dual	1
10	BW0304		reduction	1
10	BW0310		cable support	

10	EA0329		screw	
10	TP0090		tig handle	1
15	CX0080		tig plug 50 – gas quick conn.	

CODE	CABLE	
11	TH0147	4 m / 12.5' 1
11	TH0148	8 m / 25' 1
12	TH0086	4 m / 12.5'
12	TH0087	8 m / 25'

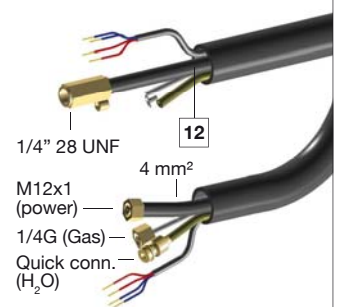

FOR ALL CONSUMABLES SEE PAGE 469