

# ERGOTIG 24W









CE EN60974-7



CODE	↔	↔	↔
------	---	---	---

SY1410-00	4 m	12.5'	sintig	 TSK 50-1/4G
SY1810-00	8 m	25'	sintig	
SY2410-00	4 m	12.5'	dual	
SY2810-00	8 m	25'	dual	
SZ1410-00	4 m	12.5'	sintig flex	
SZ1810-00	8 m	25'	sintig flex	
SZ2410-00	4 m	12.5'	dual flex	
SZ2810-00	8 m	25'	dual flex	

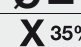
TECHNICAL DATA		
----------------	--	--

		
	0,45 kg	0.99 lb
	113	
	Argon	
	0,5 ÷ 1,6 mm	.020" ÷ 1/16"
	180A DC - 120A AC	



## CONSUMABLES KIT

- TT0101 1,6 mm 1/16"
- TT0102 2,4 mm 3/32"

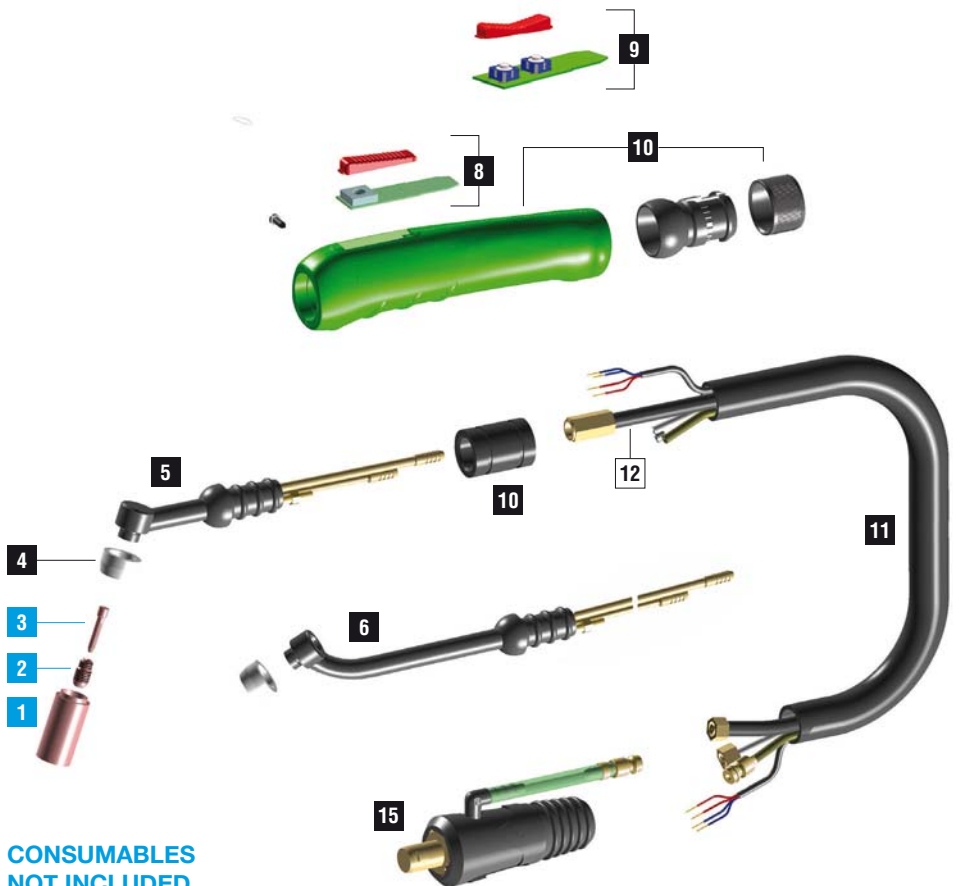
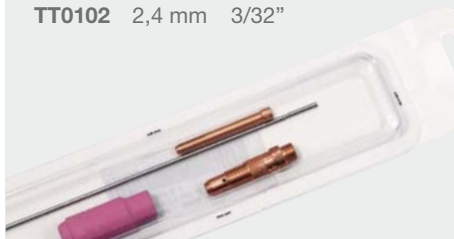

**CONSUMABLES NOT INCLUDED**

	CODE		Gr	Ø		↔	REF	
1	TC0021		.165	4 mm	5/32"		53N23	10
1	TC0022		4	6,4 mm	1/4"		53N24	10
1	TC0023		5	8 mm	5/16"		53N25	10
1	TC0024		6	9,8 mm	3/8"		53N27	10
1	TC0027		4	6,4 mm	1/4"		53N28	10
1	TC0028		6	9,8 mm	3/8"		53N26	10
2	TE0004-05			0,5 mm	.020"		53N17	10
2	TE0004-10			1,0 mm	.040"		53N18	10
2	TE0004-16			1,6 mm	1/16"		53N19	10
2	TE0004-24			2,4 mm	3/32"		24CB332	10
3	TD0004-05			0,5 mm	.020"		53N15	10
3	TD0004-10			1,0 mm	.040"		53N16	10
3	TD0004-16			1,6 mm	1/16"		53N14	10
3	TD0004-24			2,4 mm	3/32"		24C332	10

	CODE			
4	TQ0004		insulator	10
5	TG0024		tig torch head 56 mm	1
6	TG0224		tig torch head Flex 118 mm	1
8	TT0181		kit Ergotig single	1
9	TT0182		kit Ergotig dual	1
10	BW0303		reduction	1
10	BW0310		cable support	1
10	EA0329		screw	
10	TP0090		tig handle	1
15	CX0080		tig plug 50 – gas quick conn.	

	CODE	CABLE	
11	TH0147	4 m / 12.5'	1
11	TH0148	8 m / 25'	1
	CODE	↔	
12	TH0086	4 m / 12.5'	
12	TH0087	8 m / 25'	

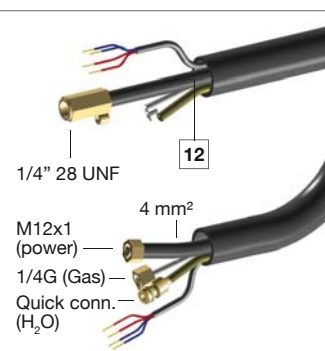

FOR ALL CONSUMABLES SEE PAGE 469